

Building Sketch

Borrower				
Property Address 7001 E Smith Ferry Rd				
City	Muskogee	County	State	OK Zip Code 74403
Lender/Client				

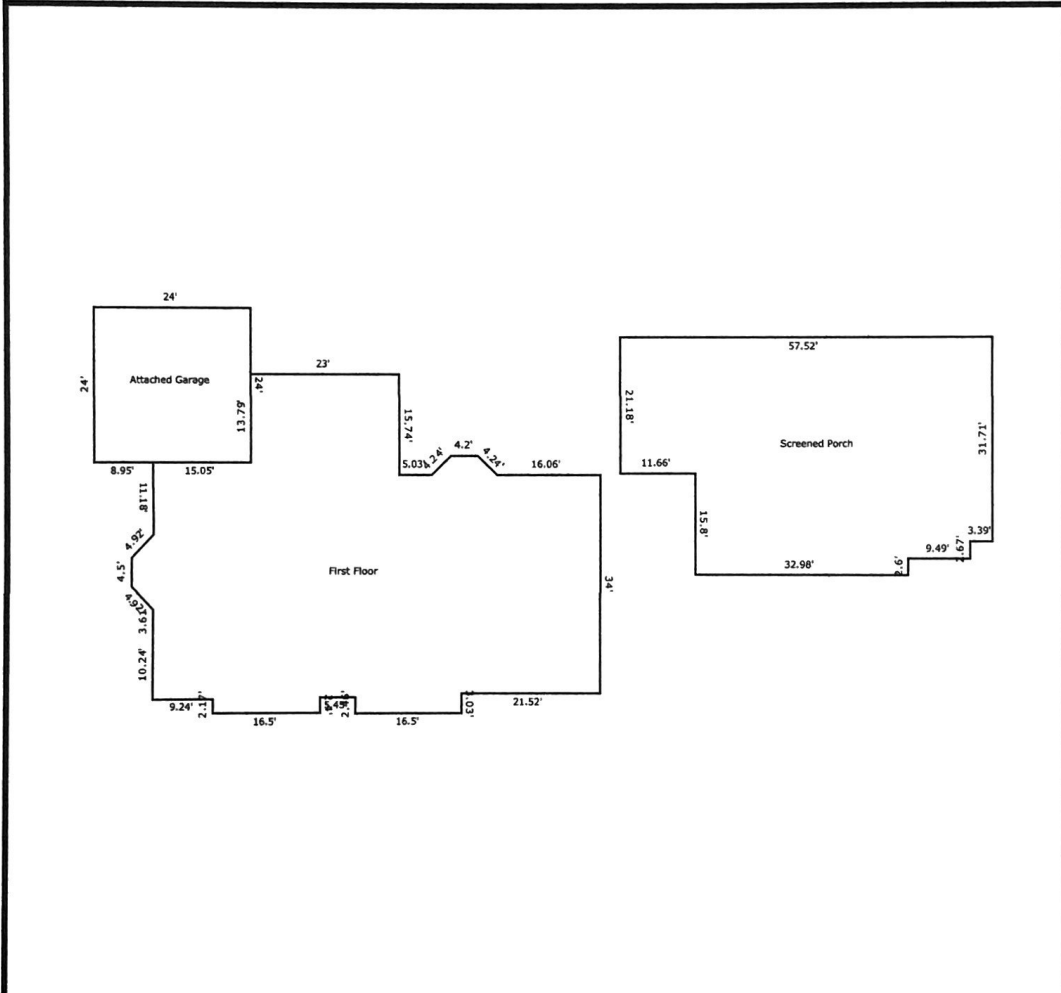

TOTAL Sketch by a la mode, inc.

Area Calculations Summary

Living Area	Area Calculations Summary	Calculation Details
First Floor	2903.17 Sq ft	$0.5 \times 3 \times 3 = 4.5$ $0.5 \times 3 \times 3 = 4.5$ $4.2 \times 3 = 12.6$ $0.5 \times 3.61 \times 3.34 = 6.03$ $0.5 \times 3.34 \times 3.61 = 6.03$ $4.5 \times 3.34 = 15.03$ $34 \times 21.52 = 731.68$ $37.03 \times 9.77 = 361.78$ $52.77 \times 6.73 = 355.14$ $50.31 \times 5.45 = 274.19$ $52.71 \times 10.82 = 570.32$ $38.92 \times 5.68 = 221.07$ $36.75 \times 9.24 = 339.57$ $0.5 \times 11.18 \times 0.13 = 0.73$
Second Floor	1900.32 Sq ft	$21.18 \times 11.66 = 246.96$ $36.98 \times 32.98 = 1219.6$ $12.88 \times 31.71 = 408.42$ $2.67 \times 9.49 = 25.34$
Total Living Area (Rounded):	4803 Sq ft	
Non-living Area		
2 Car Attached	576 Sq ft	$24 \times 24 = 576$