

SURVEY FOR:
SONDRA DENNEY

PLAT OF SURVEY

NO EASMENTS PROVIDED

20 - T13N - R14E

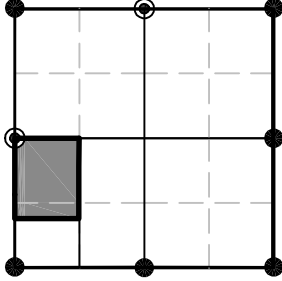

TRACT 1: LEGAL DESCRIPTION FOR 15 AC FROM DEED (2411/711)

THE NORTH TEN (10) ACRES OF THE SOUTHWEST QUARTER OF THE SOUTHWEST QUARTER (SW/4 SW/4) AND THE SOUTH 5 ACRES OF THE NORTHWEST QUARTER OF THE SOUTHWEST QUARTER (NW/4 SW/4) OF SECTION TWENTY (20), TOWNSHIP THIRTEEN (13) NORTH, RANGE FOURTEEN (14) EAST OF THE INDIAN MERIDIAN, OKMULGEE COUNTY, STATE OF OKLAHOMA.

TRACT 2: NEW LEGAL DESCRIPTION FOR 17.49 AC, REFERENCE DEED (2411/711)

A TRACT OF LAND IN THE (NW/4 SW/4) OF SECTION TWENTY (20), TOWNSHIP THIRTEEN (13) NORTH, RANGE FOURTEEN (14) EAST OF THE INDIAN MERIDIAN, OKMULGEE COUNTY, STATE OF OKLAHOMA. DESCRIBED BY METES AND BOUNDS AS FOLLOWS:

COMMENCING AT THE NW CORNER OF SAID NW/4 SW/4; THENCE S00°57'24"E ALONG THE WEST LINE OF SAID NW/4 SW/4 A DISTANCE OF 578.28 FEET TO THE POINT OF BEGINNING; THENCE N88°58'32"E A DISTANCE OF 1318.25 FEET; THENCE S00°54'08"E ALONG THE EAST LINE OF SAID NW/4 SW/4 A DISTANCE OF 577.69 FEET; THENCE S88°57'00"W ALONG THE NORTH LINE OF THE SOUTH 5 ACRES OF THE NW/4 SW/4 A DISTANCE OF 1317.71 FEET; THENCE N00°57'24"W ALONG THE WEST LINE OF SAID NW/4 SW/4 A DISTANCE OF 578.28 FEET TO THE POINT OF BEGINNING; SAID TRACT CONTAINING 17.49 ACRES MORE OR LESS.

TRACT 3: NEW LEGAL DESCRIPTION FOR 17.49 AC, REFERENCE DEED (2411/711)

A TRACT OF LAND IN THE (NW/4 SW/4) OF SECTION TWENTY (20), TOWNSHIP THIRTEEN (13) NORTH, RANGE FOURTEEN (14) EAST OF THE INDIAN MERIDIAN, OKMULGEE COUNTY, STATE OF OKLAHOMA. DESCRIBED BY METES AND BOUNDS AS FOLLOWS:

BEINNING AT THE NW CORNER OF SAID NW/4 SW/4; THENCE N89°00'03"E ALONG THE NORTH LINE OF SAID NW/4 SW/4 A DISTANCE OF 1318.80 FEET TO THE NE CORNER OF SAID NW/4 SW/4; THENCE S00°54'08"E ALONG THE EAST LINE OF SAID NW/4 SW/4 A DISTANCE OF 577.69 FEET; THENCE S88°58'32"W A DISTANCE OF 1318.25 FEET; THENCE N00°57'24"W ALONG THE WEST LINE OF SAID NW/4 SW/4 A DISTANCE OF 578.28 FEET TO THE POINT OF BEGINNING; SAID TRACT CONTAINING 17.49 ACRES MORE OR LESS.

0 300 600 900



MILLIGAN LAND SURVEYING PLLC

216 Peaceable Ridge,
McAlester, OK 74501
OK CA# 5298
918.429.5999
willmilligan@sbcglobal.net

18760 HWY NO 52
MORRIS OK 74445
DATE OF FIELD SURVEY: 3-19-2026
SCALE 1"=300'
BASIS OF BEARINGS: N00°57'24"W ALONG THE WEST LINE
OF THE SW/4 FROM SPC OK SOUTH ZONE

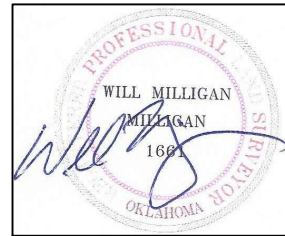

Witness my hand and seal on this 23rd day of March, 2026

49.5' STATUTORY ROADWAY

STATE HWY NO. 52

2643.54'

25.70' TO R/W

SET 3/8" IP

N 00°57'24" W

SET 3/8" IP

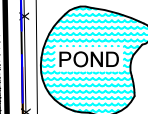

N 00°57'24" W

SET 3/8" IP

N 00°57'24" W

SET 3/8" IP

23.73' TO R/W

I, Will Milligan, Professional Land Surveyor #1661 in Oklahoma do hereby certify to the party shown that this is a true representation of a survey performed under my supervision and according to the Oklahoma Minimum Standards.

- SET IRON PIN & CAP
- EXISTING REBAR
- EXISTING STONE
- △ EXISTING MONUMENT
- NAIL
- RAILROAD SPIKE

1318.80'
N 89°00'03" E

SET 3/8" IP

S 00°54'08" E

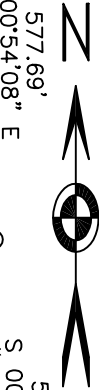

S 00°54'08" E

S 00°54'08" E

SET 3/8" IP

TRACT 3
17.49 AC +/-

TRACT 2
17.49 AC +/-

TRACT 1
14.98 AC +/-

BARN

HOUSE

SHED

NW/4 SW/4

S 5 AC
NW/4 SW/4

N 10 AC
SW/4 SW/4

1317.23'
S 88°55'42" W

SET 3/8" IP

SET 3/8" IP